

## Product data

### Design flooring MeisterDesign. comfort

## DB 600 S

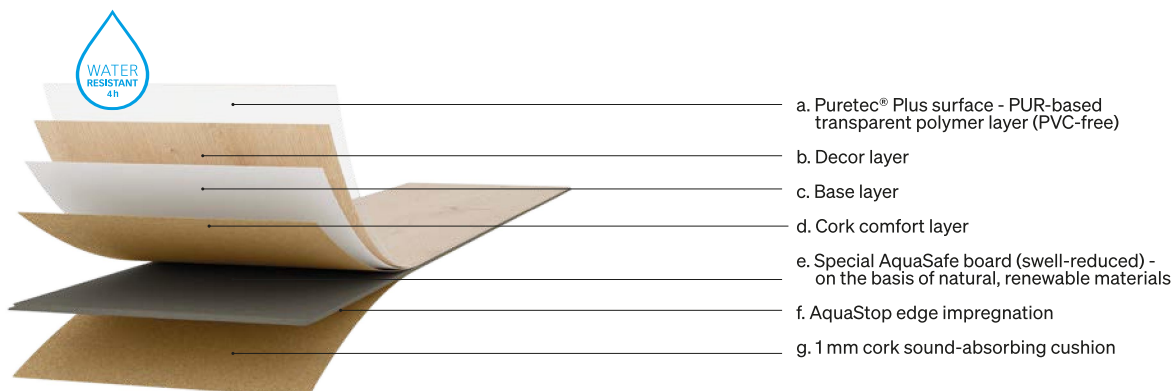









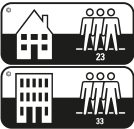





| Tests | DIN/EN standard | Design flooring<br>MeisterDesign. comfort DB 600 S |
|-------|-----------------|--|
|-------|-----------------|--|

#### General data on product composition

|  |  |  |
|--|--|--|
| Type of covering:                          | Semi-rigid multi-layer flooring panel with an abrasion-resistant decorative top layer  |  |
| Total thickness:                           | approx. 9 mm   |  |
| Effective measurement:<br>(length × width) | 853 × 395 mm   |  |
| Product structure:                         | a. Puretec® Plus surface - PUR-based transparent polymer layer (PVC-free)<br>b. Decor layer<br>c. Base layer<br>d. Cork comfort layer<br>e. Wood fibre board (approx. 890 kg/m <sup>3</sup> ± 3%)<br>f. AquaStop edge impregnation<br>g. 1 mm cork sound-absorbing cushion |  |

#### Technical data

|   |                                 |   |
|---|---------------------------------|---|
| Locking method:   | Masterclik Plus                 |   |
| Wear class:   | ISO 10 874                      | 23 / 33   |
|  |                                 |   |
| Wear resistance:  | EN 13 329<br>(procedure A)      | IP ≥ 2 000 cycles   |
|  | Antibacterial surface property: | ISO 22196   |
|   |                                 | Effectiveness of the antibacterial property against Staphylococcus aureus ATCC 6538P and Escherichia coli ATCC 8739: "strong"; value of the antibacterial effect A ≥ 3.   |
|  | Impact resistance:              | EN 13 329<br>(appendix F)   |
|   |                                 | ≥ 1600 mm   |
|  | Stain resistance:               | EN 438-2/25   |
|   |                                 | Group 1: grade 5<br>Group 2: grade 5<br>Group 3: grade 4<br>Coloured rubber, natural rubber or plastic glides and castors as well as dark car, bike or equipment tyres may possibly cause discolouration on flooring. Please only use light, non-migrating furniture glides, castors or tyres, if possible. |
|  | Colour fastness:                | EN ISO 105-B02  |
|   |                                 | ≥ stage 6 on the blue wool scale / ≥ stage 4 on the grey scale  |
|  | Fire behaviour:                 | EN 13 501   |
|   |                                 | Bfl-s1 (hardly flammable)   |
|  | Slip resistance:                | EN 14 041 /<br>13 893   |
|   |                                 | DS  |

| Technical data  |   |   |   |
|---|---|---|---|
|  | Formaldehyde emissions (E1 = 0.1 ppm):              | EN 717-1  | ≤ 0.05 ppm  |
|  | Content of pentachlorophenol:                       | EN 14 041 / 14 823  | < 5 ppm   |
|  | Indent after constant load:                         | EN ISO 24343-1  | ≤ 0.1 mm  |
|  | Castor resistance:                                  | ISO 4918  | no visible changes or damage with soft, standard castors (type W) |
|  | Behaviour on simulation of shifting furniture foot: | EN ISO 16581  | Foot type 0: no visible damage                                    |
|  | Underfloor heating:                                 | Suitable for hot-water underfloor heating Electrical underfloor heating is generally suitable when it is built into the floor screed or the concrete layer and thus does not lie on the concrete layer as foil heating. The heating elements   pipes   wires must lie across the entire area and not just be partly present. If the area is only partially heated, the floor covering must have expansion joints (system profile strips). The maximum permitted surface temperature is 29°C. Standard foil heating systems are generally not recommended. One exception is self-regulating heating systems which maintain the 29°C surface temperature. |   |
|   | Underfloor cooling:                                 | A separate leaflet is available for laying on cooled floor constructions.   |   |
|   | Heat transfer resistance:                           | EN 12 667   | 0.088 (m²K)/W   |
|   | Thermal conductivity:                               | EN 12 667   | 0.109 W/(m*K)   |
|  | Footfall noise reduction:                           | DIN EN ISO 10140-3  | 17 dB   |
|   | Antislip:   | DIN EN 16165 (appendix B)   | R 10  |

### Tolerances

|                                     |           |                   |
|-------------------------------------|-----------|-------------------|
| Right-angle of the elements:        | EN 16 511 | target values met |
| Determination of edge straightness: | EN 16 511 | target values met |
| Surface flushness:                  | EN 16 511 | target values met |
| Joint opening between the elements: | EN 16 511 | target values met |

### General data on environment, installation and care

|                                 |   |  |
|---------------------------------|---|--|
| Blue Angel:                     | RAL-UZ 176  | awarded  |
| Disposal:                       | Residual pieces can be disposed of in household refuse (e.g. thermal treatment) Dispose large quantities according to municipal provisions (e.g. recycling centres). An energetic utilisation in authorised plants is recommended.  |  |
| Cleaning and care:              | Cleaning after construction work: Dr. Schutz PU Cleaner<br>Regular cleaning: Dr. Schutz PU Cleaner<br>Freshening care: Dr. Schutz Floor Mat   |  |
| Areas of application:           | The flooring is suitable for all living areas as well as for commercial areas with heavy wear, e.g. open-plan offices, department stores, public buildings etc. The design floor is water-resistant (4 hours protection against standing water). Can be installed in humid rooms like e.g. bathrooms. This does not include outdoor areas and wet rooms, e.g. saunas, shower cubicles, steam rooms and rooms with a floor drain. Special requirements apply to treatment rooms and medical practices. |  |
| Preconditions for installation: | DIN 18 365  | The substrates must be ready for laying on according to the generally recognised rules of the trade, taking into account VOB (German construction contract procedures), part C DIN 18 365 "Floor covering work". The substrate must be dry (in the case of mineral substrates max. 2% or with underfloor heating 1.8 %, with anhydrite screed max. 0.5% or with underfloor heating 0.3 % residual moisture – measured with CM devices), even, firm and clean. Additionally, any unevenness of 3 mm/ per initial metre and 2 mm per further metre must be evened out according to DIN 18 202, table 3, line 4.The installation instructions provided with the product must be observed. |



MeisterWerke Schulte GmbH reserves the right to make alterations to material and structures when this serves to improve the quality.

# Installation and care instructions – *compact version*

**MEISTER**

## Design flooring MeisterDesign with Mastercllic Plus technology

### Preparatory measures, substrates and general instructions



Video tutorial for  
Mastercllic Plus

#### Preparation

**The packages must be acclimatised before you open them. Store them for approx. 48 hours (3–4 days in winter) (Fig. 1) unopened and flat on the floor in the centre of the room you want to work in.**

Do not store the packages in front of damp or freshly wallpapered walls. Before you install the flooring, outer doors and windows must be installed and all painting and decorating work must be finished. The room temperature must be approx. 20°C (at least 15°C), and the relative humidity must be approx. 30–65 per cent.

The substrates must be considered as ready-to-lay in accordance with the generally accepted rules of the trade, taking into account VOB (German Construction Contract Procedures), Part C, DIN 18 356 »Parquetry« or DIN 18 365 »Floor covering work« respectively. Therefore, they must be dry, even, solid and clean. Any substrate unevenness of three or more millimetres for each initial metre and two or more millimetres for each subsequent continuous metre must be evened out according to DIN 18 202, table 3, line 4 (Fig. 2). We recommend consulting technical information sheet 02 from the Zentralverband für Parkett und Fußbodentechnik (Central Association for Parquet Flooring and Flooring Technology) and the BEB (German Federal Association of Screed and Floor Covering).

The residual humidity, measured using the CM method, of mineral substrates must be no more than 2 per cent (1.8 per cent for underfloor heating) and that of anhydrite screeds must be a maximum of 0.5 per cent (0.3 per cent for underfloor heating) (Fig. 3). For installation over underfloor heating systems or underfloor heating systems with cooling function, separate information sheets are available.

0.2 mm thick PE film (SD value  $\geq 75$  m) must be laid out on all mineral substrates (except poured asphalt screed) as a vapour barrier (Fig. 4). The strip edges must overlap by at least 20 cm and the overlapping edges must be masked off at the sides. Alternatively, you

can use MEISTER insulating underlay with an integrated moisture-resistant barrier. In rooms that are not above a cellar and foundations, the currently valid building conditions require that the owner of the building provide a barrier against damage to the base plate due to moisture from the ground, in accordance with the DIN 18 195 directive.

Textile flooring such as carpet or needle fleece must be removed not only for technical reasons, but for hygiene reasons, too (Fig. 5).

MEISTER flooring can be laid on existing surfaces, such as ceramic tiles and boards or stone floors, so long as the old flooring is firmly bonded and there are no loose areas. You should also spread out a PE film (SD value  $\geq 75$  m) on these subfloors as a separating layer (Fig. 6).

On existing PVC, wooden planks, wood-based boards, OSB boards, drywall elements, etc., no vapour barrier must be used (Fig. 7 + 8).

If the floor area is longer or wider than 10 m (Fig. 9), you must provide an expansion joint. Cover this with a transition profile. It is also important to provide these joints between two adjacent rooms, in doorways (Fig. 10), passageways and rooms with a lot of angles. Always use a jointing profile for clean transitions to adjacent, lower areas or floor coverings and an end profile next to higher adjacent thresholds, tiles or the like. Give stairs a clean finish with the stair edge profile.

**MEISTER flooring is not suitable for installation in humid/wet rooms (bathrooms, saunas, swimming pool etc.).**

**The MeisterDesign. comfort design flooring can also be installed in humid rooms (Class W0-I, e.g. bathrooms). They are not suitable for installation in outdoor areas or wet rooms such as showers, saunas, public washrooms or rooms with a floor drain (Fig. 11) – see separate briefing note.**

All MEISTER floorings are suitable for installation in home conservatories (Fig. 12). Shading and ventilation systems must be used to avoid strong sunlight and prevent the flooring from heating up. It is important to maintain a suitably consistent temperature for the living space all year round. The surface temperature of the floor must not permanently exceed 29°C – see separate briefing note.

Before installation, check all planks in daylight for recognisable faults and damages, as well as colour and structure (Fig. 13).

Arrange the planks before laying so that you achieve the floor pattern and colour you want (Fig. 14). You cannot make a claim for any products you have already installed.

#### Precautionary measures

To protect the wood from dirt, a sufficiently large entrance covering must always be laid (such as a doormat or carpet) (Fig. 15). Do not use any rubber-coated mats, since prolonged contact can lead to permanent discolouration, especially in design flooring.

In addition, you should also fit chair and furniture feet with felt sliders; office chairs, mobile containers, etc., on castors must be equipped with soft, standard running surfaces (type W) (Fig. 16). Coloured rubber, natural rubber or plastic glides and castors as well as dark car, bike or equipment tyres may possibly cause discolouration on design flooring. Please only use light, non-migrating furniture glides, castors or tyres, if possible.

## Preparation

**1** min. 48 h  
30–65%  
> 15°C

**2** 1000 mm  
< 3 mm/m

**3** CT: < 2 CM%  
CA/CAF: < 0.5 CM%  
CT: < 1.8 CM%  
CA/CAF: < 0.3 CM%

**4** SD Min. 75 mm  
200 mm  
H<sub>2</sub>O STOP

**5**

**6** H<sub>2</sub>O STOP

**7** PVC  
H<sub>2</sub>O STOP

**8** H<sub>2</sub>O STOP

**9** 8–10 mm  
max. 10 × 10 m

**10** 8–10 mm

**11**

**12** 30–65%  
Max. 29°C

**13**

**14** A B C

## Precautionary measures

**15**

**16** Type W

## Installation



### Fig. A1 + A2

The flooring is installed as a floating structure without glue. The Masterclit Plus connection system makes it possible to install the flooring quickly and easily. The end interlocking occurs when the next row is laid. In addition, it is a valuable installation aid, as the planks can be aligned against each other in this way. To do this, you should lift the plank slightly and simply square it with the tongue in the groove of the plank that has already been laid.

### Fig. 1

You will need the following tools and aids to install MeisterDesign design flooring with Masterclit Plus technology:

Hammer, keyhole or electric saw, possibly power drill, folding metre rule, pencil, wedges (spacer wedges), heel bar, angle or adjustable bevel, possibly PE film (0.2 mm). Furthermore, if you are using products without a sound-absorbing Silence cushion, use the system-bound MEISTER insulating underlay. Any other insulating underlay must have a suitable pressure stability (CS value  $\geq 15$  kPa).

### Fig. 2

Remove any dirt, small stones, etc. from the surface prior to installation.

### Fig. 3

PE film 0.2 mm thick must be laid out to form a "bath" on all mineral substrates (except poured asphalt screed) as a vapour barrier. The strip edges must overlap by at least 20 cm and the overlapping edges must be masked off. Alternatively, the option is available to use MEISTER insulating underlay with integrated vapour barrier.

### Fig. 4

Lay the corresponding MEISTER insulating underlay with a pressure resistance of  $> 15$  kPa in the private residential sector or  $> 60$  kPa in the commercial sector.

### Fig. 5

Before installation, check all planks in daylight for recognisable faults in colour and structure. Goods already installed cannot be claimed for later.

### Fig. 6

Install a mixture of planks from different packages.

### Fig. 7

When sawing the elements, make sure you work from the correct side: if you use a bench saw, keep the decorative side facing up, if you use a keyhole or portable circular saw, keep the decorative side down.

Start by laying the first complete plank in the left-hand corner of the room with the tongue sides facing the wall. Remove only the tongues on the long sides of all the other planks you want to lay in the first row. Using wedges, you can easily keep a gap of at least 10 mm from the wall.

### Fig. 8

Insert the head end of the next complete plank into plank 1. Install the other planks in this row in exactly the same way across the entire width of the room.

### Fig. 9

The last planks in each row are cut to size so that a gap of 10 mm to the wall is taken into account. You can use cut-off pieces of planks to start subsequent rows.

### Fig. 10

Make sure that the planks in the first row are straight. Cut the first plank of the second row down to approx. 80 cm (or, for MeisterDesign. comfort DB 600 S, 50–60 cm).

Fix this plank upright with the tongue as far as possible into the groove on the groove side of the previous row of planks and press the plank down slowly using a forward and downward turning motion. The plank has to click into the previously installed row.

### Fig. 11

Similarly, the next complete plank is turned into the click connection on the long side and the head end pushed tight against the previous plank before it is lowered. Then press the plank down slowly using a forward and downward turning motion. The plank has to click into the previously installed row and the end joint with the previous plank has to be closed.

### Fig. 12

Continue installing the panels row by row in this way. Remember that the end joints must always be offset by at least 30–40 cm (or, for MeisterDesign. comfort DB 600 S, 25 cm).

### Fig. 13 + Fig. 14

Cut the last plank in each row so that you leave a gap of approx. 10 mm to the wall. Lay the plank with the tongue side facing the wall to mark the remaining plank width.

### Fig. 15

Taking the plank marked for width, push the plastic end tongue forward out of the end groove using the spare piece of plank.

### Fig. 16

Begin cutting the plank to size at the end of the plastic tongue.

### Fig. 17

After the plank has been cut to size, push the plastic tongue on the end back into the end groove. Start by laying the last row in the right-hand corner of the room (leaving at least a 10 mm gap to the wall) and angle the long side of the plank into the second-last row. The next plank is angled in the same way and lowered down at the end.

### Fig. 18

Push the plastic tongue that is pointing out towards the wall back into the end connection using a heel bar, scraper, screw driver or similar.

### Fig. 22

Next, remove the wooden wedges from around the walls.

### Fig. 23

Screw the skirting board clips to the wall at intervals of 40–50 cm. To ensure that the skirting board fits tightly, do not position it on an uneven wall.

### Fig. 24

The skirting board is placed on the clip from above and pressed down. For the length joints of the skirting boards, the clip is placed on the joint with a half overlap to ensure a good hold. Please avoid bringing any silicone products into contact with the skirting boards.

### Fig. 19 – Fig. 21

**To take a plank row back out again**, lift the entire row, levering it at the side out of the last row. You can then slide the planks apart at the ends. Should you wish to reuse the disassembled planks, you should first push the end plastic tongue back into the top groove so it sits flush.

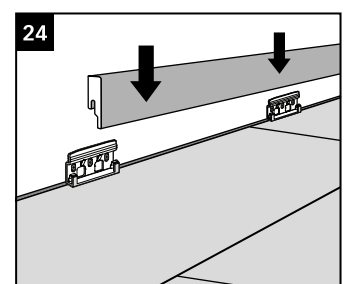
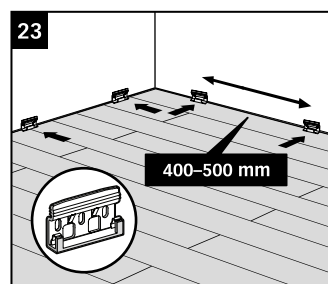
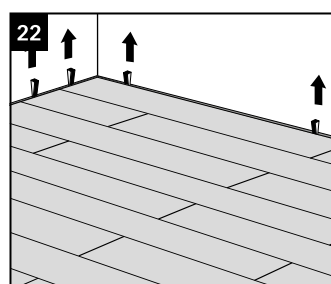
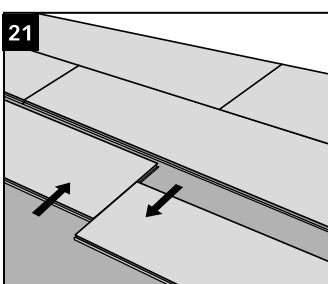
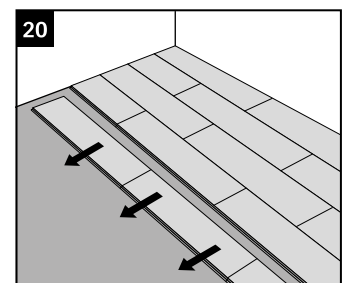
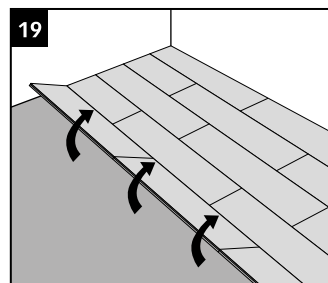
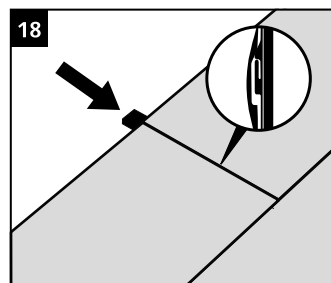
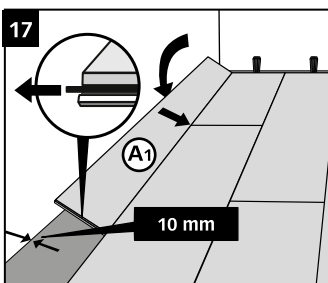
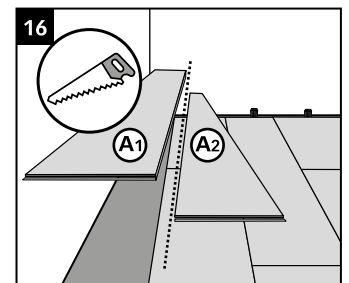
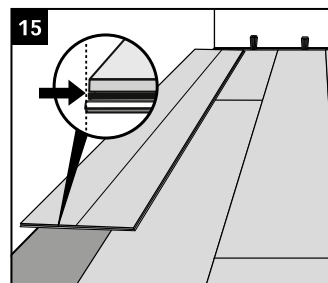
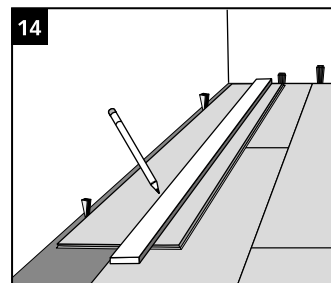
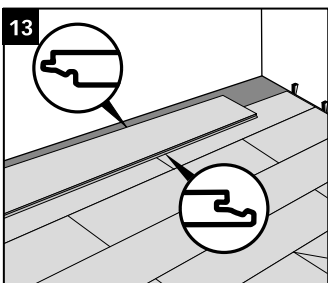
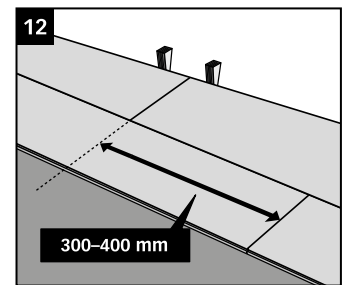
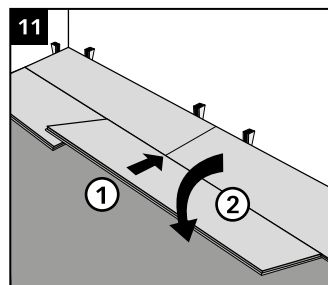
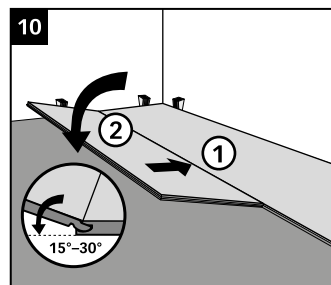
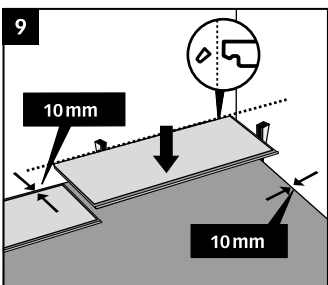
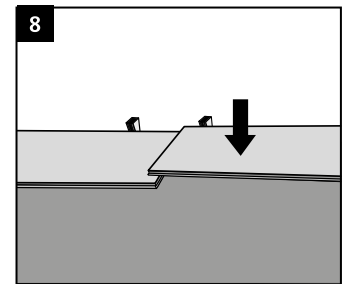
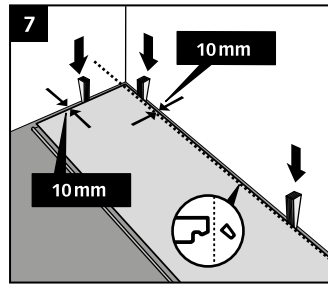
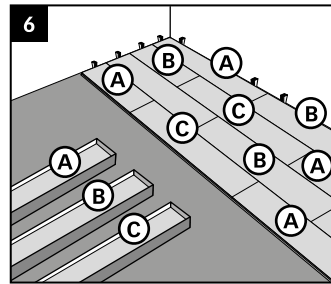
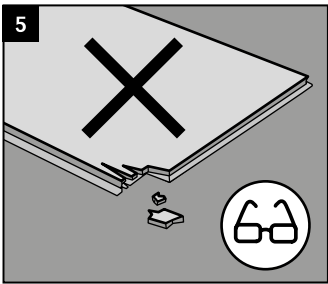
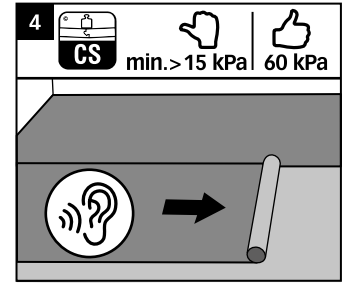
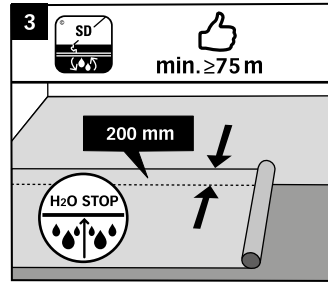
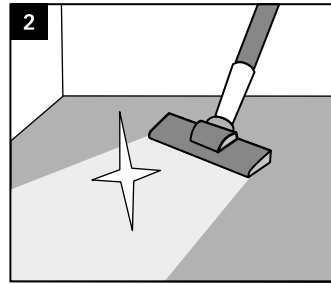
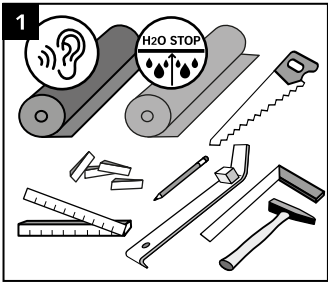
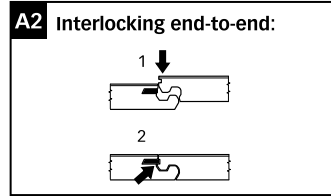
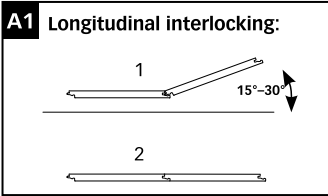

## Cleaning and care

### The quality does not stop with the installation.

You have bought a quality product "made in Germany". These cleaning and care instructions will provide you with all the information important to ensuring a long period of value preservation and a beautiful appearance of your flooring. With a bit of time and effort, you can contribute to ensuring that you are able to enjoy your new MEISTER flooring for a long time to come.

MEISTER products are based on selected materials, which are processed by experienced experts with state-of-the-art technology to create a quality product "made in Germany". The premium quality includes substantiated consultation and excellent service. For this reason, you will only find MEISTER products in selected specialist shops.

### 1. The right care

Your dream floor also needs the right care. MEISTER complements its product range with a high-quality series of care products from Dr. Schutz. Cleaners and care products, tailored for the floorings, ensure that your floor looks good in the long term. Even if you only need to run the vacuum round for day-to-day care (to remove loose dust), the surfaces should be cleaned and cared for regularly with Dr. Schutz care products to preserve the value of your floor.

When cleaning, please be aware that the floor must only ever be slightly moistened. In the ideal case, the film of water should be a thin mist, so that it dries out after about a minute. You should not use any abrasive cleaners, even in case of more severe stains.

Scratches on the floor not only affect the overall appearance. They will also make the floor more prone to dirt and moisture. The Dr. Schutz care products are designed to ensure that the floor is considerably more resistant to signs of wear and tear in heavy wear areas.

Your qualified specialist shops will also be able to provide you with more tips on how to care for your MEISTER floor in the best possible way.

### 2. Preservation of value | Precautionary measures

A room temperature of approx. 18–22°C and a relative air humidity of approx. 30–65 per cent will contribute to your personal well-being and are the basis for a healthy room climate. With such a room climate, you will also help your MEISTER floor obtain the optimal conditions, as it reacts to its climatic surroundings like any other wooden material. Low air humidity with a high temperature will lead to a contracting process in the wood, which dries the floor out. If you determine an air humidity which is considerably lower than 30 percent in the long term, we recommend the use of air humidifiers (vaporizers). This will prevent your MEISTER floor drying out excessively. As with all wooden products, very high air humidity will cause absorption of humidity, which can lead to the length and thickness increasing.

#### The introduction of dirt onto the floor:

Most dirt is brought into your home from the outside and transferred onto the flooring. For this reason, we recommend installing a sufficiently large entrance covering (such as a doormat) in the entrance. Do not use any rubber-coated mats since prolonged contact can lead to permanent discolouration. Please consider that dirt, such as sand or small stones, will act like sandpaper on all floorings and can lead to unsightly scratches. To protect the wood from scratches, you should also fit chair and furniture feet with felt sliders; office chairs, mobile containers and similar on castors must be equipped with soft, standard running surfaces (type w). Coloured rubber, natural rubber or plastic glides and castors as well as dark car, bike or equipment tyres may possibly cause discolouration on design flooring. Metal gliders can corrode if they come into contact with moisture, potentially leaving stains on the flooring. Please only use light, non-migrating furniture glides, castors or tyres, if possible. Terracotta or clay flower pots/planters can also cause discolouration. Please use suitable, non-migrating mats.

### 3. Cleaning after completion of construction work

Newly laid MEISTER floors must be cleaned after completion of construction work and before first use in order to completely remove any dirt that has collected during the course of the installation.

You should clean **MeisterDesign design flooring** after completion of construction work with Dr. Schutz PU Cleaner\*, diluted with water in a ratio of 1:10. Clean the floor using a well wrung out mop and then neutralise with clear water.

## Cleaning and care

### 4. Day-to-day cleaning

#### MeisterDesign design flooring

Loose dust and dirt is removed by vacuuming or sweeping.

Depending on the frequency and degree of dirt, the removal of bonded dirt should be carried out with Dr. Schutz PU Cleaner\*, which is diluted with water at a ratio of 1:200. The floor should be wiped using a damp mop, which has been dipped in this solution and wrung out well. Remove stubborn stains and heel marks with undiluted Dr. Schutz PU Cleaner\* and a cloth or non-scratch, white pad. Then wipe the floor with clear water. A thorough clean of the floor is required to remove particularly stubborn dirt and residues and to prepare the floor for treatment with a care product in case of visible signs of wear. For this, evenly spray Dr. Schutz Deep Clean\* undiluted on the floor and after allowing it to take effect for a short while (max. 5 minutes), scrub with a green pad or scrubbing brush. Wipe away loosened dirt using a cloth and wipe over again using clear water until all dirt and cleaner residue has been completely removed.

**Note:** If the flooring is not to receive a care treatment afterwards only use scrubbing brushes instead of green pads.

If there are signs of wear on the surface after long or intensive use, this can be refreshed with intensive maintenance after thoroughly cleaning the floor with (Dr. Schutz Deep Clean\*). To do this, apply undiluted Dr. Schutz Full Care Matt\* thinly and evenly in a lengthwise direction with a lint-free mop rinsed in clear water and wrung out well.

When the protective film can be walked on (after 45 minutes), apply a second coating in the crossways direction. Use: 750 ml for approx. 25–35 m<sup>2</sup> per application.

If the protective film is worn away over the course of time, this can be refreshed with intensive maintenance after thoroughly cleaning the floor with Dr. Schutz Deep Clean\*.

In **commercial properties** cleaning should always be possible using a cleaning machine or spray cleaning process with a disk buffing machine as well as separate value conservation measures. Please contact our technical customer services in case of application.

### 5. General information about cleaning and care

Never leave MEISTER flooring moist or wet over a long period of time. When cleaning, always try to use a dry method if possible (using a mop, hair broom, vacuum cleaner), or only wipe with a damp, wrung out cloth and do not leave any "puddles" on the floor. Steam cleaners are not suitable for the flooring. Do not use any cream cleaners, scouring powders, sanitary cleaners or harsh solvents, as these agents can attack the surface of the floor. Please only use suitable cleaners.

All kinds of chemicals, such as solvents, antiseptics and disinfectants, hair dye, fats, nail varnish remover, acetone, felt pen or ballpoint ink, many cause permanent stains.

*\*Water-based care products (e.g. polymer dispersions) can penetrate the seams of the planks in the case of improper adhesion or incomplete jointing, leading to swelling of the base material.*



The detailed installation and care instructions can be found on <https://www.meister.com/en/service.html>



## Warranty of wear resistance for MEISTERWERKE design and laminate flooring

**I. Warranty cover:** MeisterWerke Schulte GmbH, Johannes-Schulte-Allee 5, 59602 Rütten-Meiste, provides a warranty, over and beyond statutory rights under § 437 of the German Civil Code (replacement, cancellation of contract, reduction of purchase price and compensation) under the following warranty conditions. The aforementioned statutory rights, the use of which is free, are not restricted by this warranty. A warranty is provided to ensure that the decorative layer on the purchased product will not wear away within the warranty period provided the product is used properly for the purpose intended, according to the following warranty conditions. Any spot on which the decorative layer has been removed down to the base material over an area of at least 1 cm<sup>2</sup> is regarded as having worn away, though signs of wear on the edge area of an individual floor plank are excluded from this warranty. Any load on the flooring that is not the purpose for which the flooring was intended, mechanical damage and failure to comply with the MEISTERWERKE care instructions for the respective flooring exclude any claim under the warranty. The warranty applies exclusively to first choice products and use in private living areas or commercial areas depending on the wear class specified, with the exception of humid rooms, such as bathrooms or saunas. The warranty also applies to use in humid rooms such as bathrooms at MeisterDesign. allround, MeisterDesign. pro, MeisterDesign. comfort, MeisterDesign. flex, MeisterDesign. next, MeisterDesign. rigid, MeisterDesign. laminate LD 300/20, LL 200, LL 250, LL 250 S, LD 250, LL 150, LL 150 S, LB 150, LD 150 and LC 150. Use in wet rooms, such as showers, public washrooms and saunas, is not permitted. Special warranty conditions apply for the USA and Canada. This warranty does not apply in said regions.

**II. Warranty period:** The warranty period is in accordance with the warranty time stated for each individual product and for the concrete type of use described, after the appropriate date of purchase respectively. Unless a lifetime warranty in living areas was offered, this is time-limited to the normal useful life of the product. This is 30 years.

**III. Warranty conditions:** The flooring must have been fitted in accordance with the installation instructions enclosed in every third product package or that can be found on the internet at [www.meister.com/service](http://www.meister.com/service) in the permitted areas of use named within the instructions. In particular, information in the installation instructions about checking the humidity of sub-surfaces and the installation on underfloor heating must be observed. The floor must also be maintained and cleaned according to the care instructions enclosed with the product. If these installation or care instructions are missing and/or incomplete, the claimant is obliged to request this information from their specialist retailer or directly from MEISTERWERKE before fitting the flooring. The installation, cleaning and care instructions can be found at [www.meister.com](http://www.meister.com).

**IV. Reporting a warranty claim:** Any complaint must be made in text form to MEISTERWERKE (e.g. as a letter sent via the postal system, a fax, or an e-mail), enclosing a copy of the original invoice from the specialist retailer, which serves as a certificate of warranty. If it is not possible to present the original specialist retailer's invoice, any claim under the warranty is excluded. Once the claim is received by MEISTERWERKE, it must notify the customer within four weeks whether a warranty claim has been acknowledged. If no notification is given within this period, the warranty claim is deemed to have been rejected. During this period, MEISTERWERKE or a third party employed by them must be granted access to the flooring that is the subject of the complaint on site in order to investigate whether the claim is justified.

**V. Scope of the warranty:** When a warranty claim is acknowledged, MEISTERWERKE will at their discretion repair the faulty plank or alternatively provide replacement material of the same quality, if at all possible from the same range, for the respective room in which the problem has occurred. The provisions in accordance with § 439 (2), (3), (5) and (6) sentence 2 and § 475 (5) of the German Civil Code shall apply to this claim.

**VI. Limitation of warranty:** The warranty period is not extended by a warranty claim. Claims under the warranty expire six months from the date of MEISTERWERKE's receipt of the customer's written complaint (see IV.), but no earlier than the expiry of the warranty period.

**VII. Choice of law:** This warranty is subject to German law, to the exclusion of the United Nations Treaty governing contracts for the international sale of goods. However, this does not affect the legal provisions regarding the limitation of the choice of law; in particular and in accordance with Art. 6 (2) of EC Regulation (EC) No. 593/2008 (the "Rome I Regulation"), the beneficiary of the warranty can, irrespective of the choice of law and in accordance with Section 1, invoke the mandatory protection of the law that would apply in the absence of this choice of law.